

# TOWNSHIP 9 NORTH, RANGE 2 EAST, W.R.M.

## HOT SPRINGS COUNTY, WYOMING

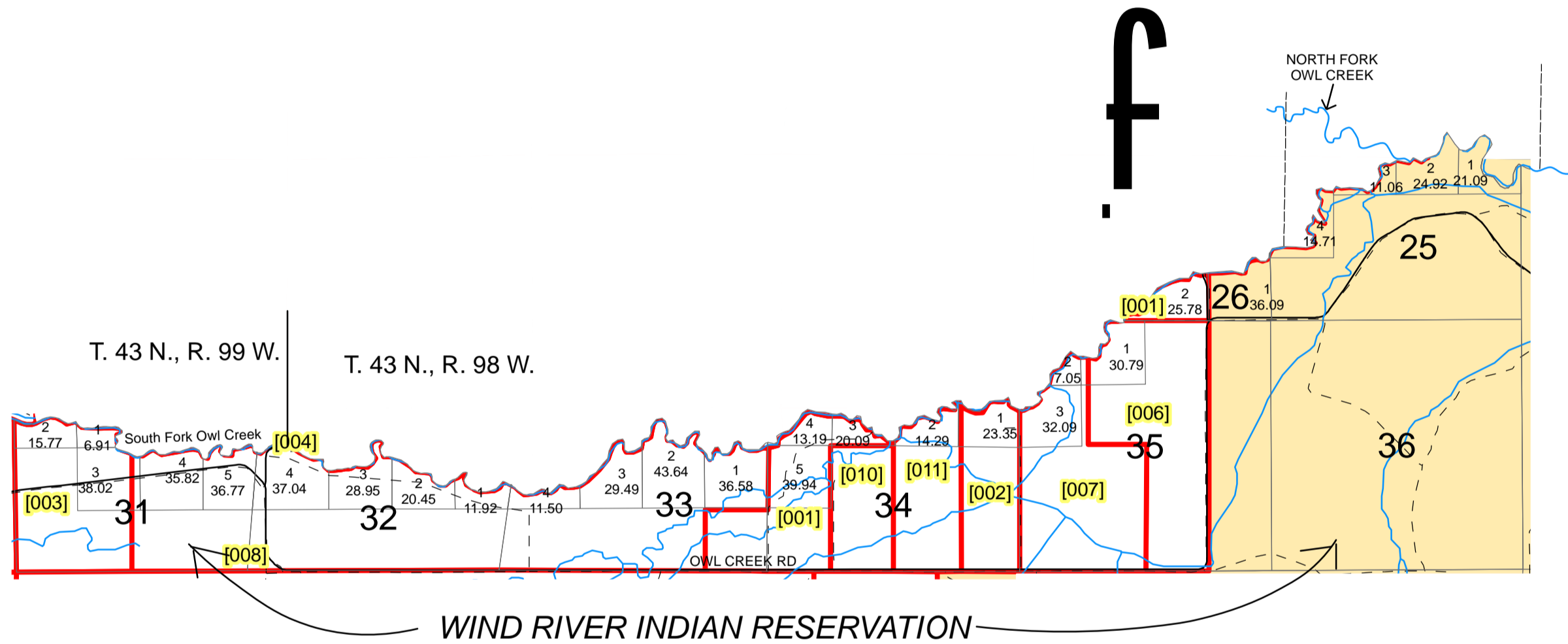

### Legend

- Private
- USA\_Lands
- County\_Roads
- Hydrology
- Private\_Roads

1 inch equals 2,640 feet

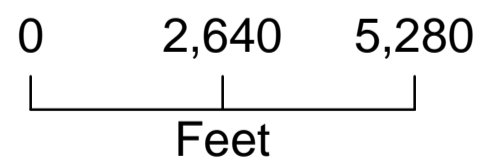

All or portion of the PLSS information on this document is subject to copyright by premier Data Services, they are not liable for any errors or inaccuracies.

The Hot Springs County Assessors office intends this map to be an aid in graphic representation of the displayed subject matter only.

Hot Springs County Assessor's Office  
 Drawn by CGB 08/17/06  
 Revised 12/31/2008 jmc  
 Revised 7/15/2009

## Township 9 N Range 2 E Wind River Meridian

Plat #	Owner	Account	County #	Acres	Legal Description
001	H-TRIANGLE LIVESTOCK CO INC	R0003731	0682	179	9N-2E-26 LOT 2 9N-2E-33 SESE 9N-2E-34 LOTS 3,4,5, SWSW TOTAL ACRES 179.0
002	ALLEN MAURICE R & LYNN S	R0003734	0005	103.35	9N-2E-34 E/2SE, LOT 1 ACRES 103.35 CORRESPONDS W/ PARCEL #5900
003	CAMPBELLS INC	R0003732	0450	177.08	9N-2E-31 LOTS 1,2,3, W/2SW/4, SESW LESS 3.62 ACRES HWY TOTAL ACRES 177.08 CORRESPONDS W/ PARCEL #5909
006	NORTHERN ARAPAHO TRIBE	R0003737	0383	226.79	9N-2E-35 LOT 1, SENW, W/2SE, W/2NE (LESS 4 ACRES RD) TOTAL ACRES 226.79
007	BELTZ RICHARD L & NORMA E	R0003738	0249	192.09	9N-2E-35 LOT 3, E/2SW W/2SW TOTAL ACRES 192.09 DECAL #088
008	HAY CREEK LAND & CATTLE CO LLC	R0003733	3172	646.84	9N-2E-31 LOTS 4,5, S/2SE 9N-2E-32 LOTS 1,2,3,4, S/2S/2 9N-2E-33 LOTS 1,2,3,4, SESW, SWSE, SWSW TOTAL ACRES 646.84 CORRESPONDS W/ PARCEL #5937
010	HOOVER REYNOLD N & LUCY ANN	R0003735	3829	79.99	9N-2E-34 E/2SW 79.996 ACRES
011	ALLDREDGE ARTHUR WILLIAM	R0003736	3830	94.27	9N-2E-34 W/2SE AND LOT 2 94.27 ACRES
501	U.S. I.T., PADLOCK & WIND RIVER INDIAN RESERVATION	None		1187.87	9 N 2 E Sections: 25,26,35,36