

# TOWNSHIP 8 NORTH, RANGE 2 EAST, W.R.M.

## HOT SPRINGS COUNTY, WYOMING

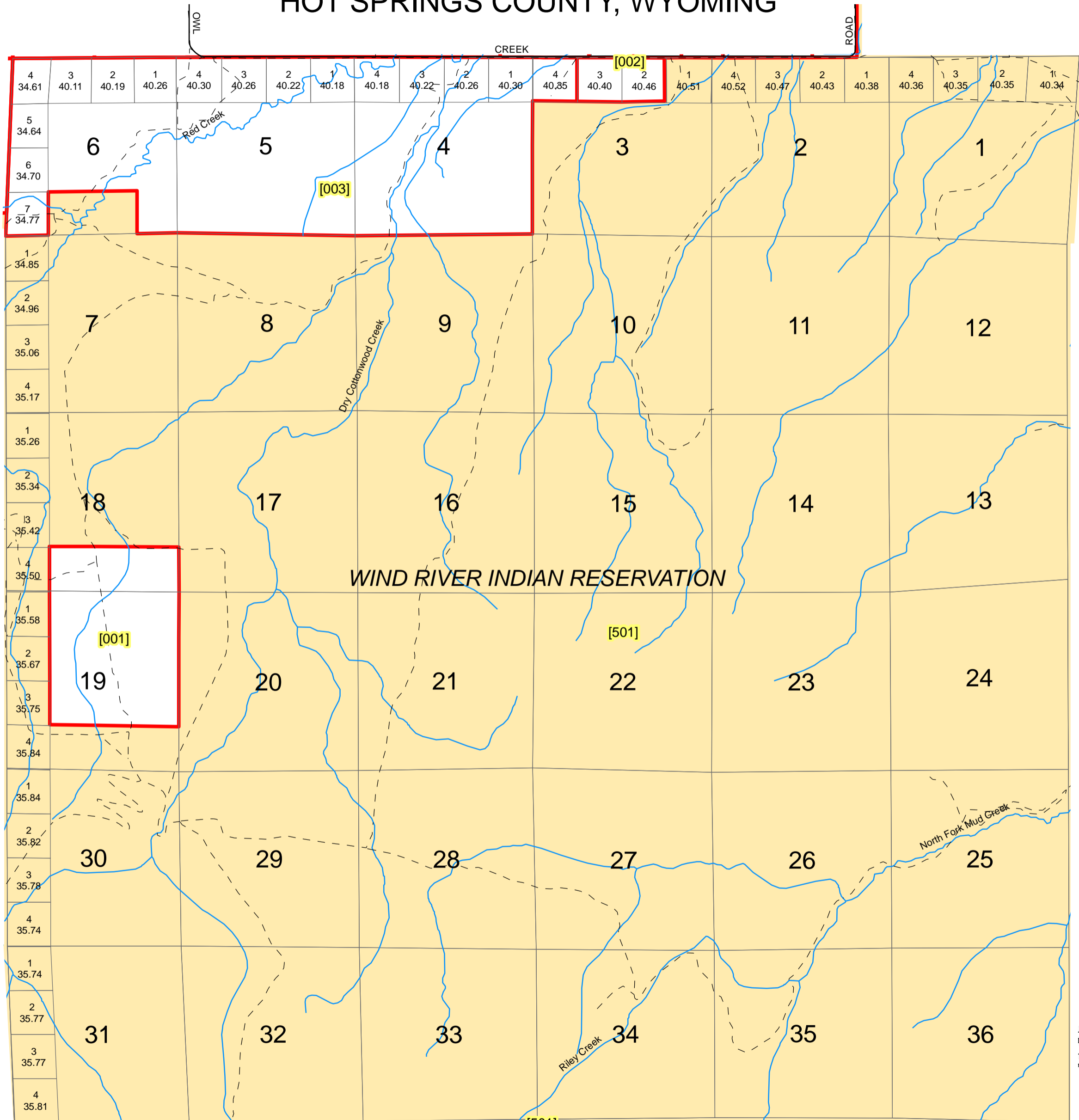

£

1 inch equals 2,640 feet

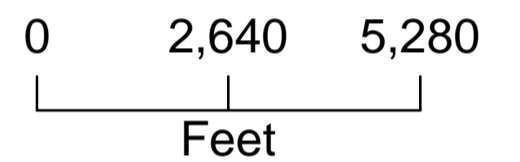

### Legend

- Private
- US\_Lands
- County\_Roads
- Private\_Roads
- Hydrology

All or portion of the PLSS information on this document is subject to copyright by premier Data Services, they are not liable for any errors or inaccuracies.

The Hot Springs County Assessor's office intends this map to be an aid in graphic representation of the displayed subject matter only.

Hot Springs County Assessor's Office  
 Drawn by CGB 08/16/06  
 Revised 12/31/2008 jmc  
 Revised 7/15/2009

## Township 8 N Range 2 E Wind River Meridian

| Plat # | Owner                                     | Account  | County # | Acres    | Legal Description  |
|--------|---|----------|----------|----------|--|
| 002    | STOTHART ROBERT FORD & MARGOT JANET       | R0003653 | 0019     | 79.36    | 8N-2E-03 LOT 3, LOT 2 LESS 1.5 A RD TOTAL ACRES 79.36 CORRESPONDS W/ PARCEL #5968  |
| 003    | HAY CREEK LAND & CATTLE CO LLC            | R0003654 | 3169     | 1855.48  | 8N-2E-03 LOT 4 8N-2E-04 LOTS 1,2,3,4,S/2N/2,S/2 8N-2E-05 LOTS 1,2,3,4,S/2N/2,S/2 8N-2E-06 LOTS 1,2,3,4,5,6,7, S/2NE, SENW, NESW, N/2SE, SESE TOTAL ACRES 1855.48 CORRESPONDS W/ PARCEL #5937 |
| 501    | U.S. I.T. & WIND RIVER INDIAN RESERVATION | None     |          | 20521.98 | 8 N 2 E Sections:  |
|        |   |          |          |          |  |
|        |   |          |          |          |  |
|        |   |          |          |          |  |
|        |   |          |          |          |  |
|        |   |          |          |          |  |
|        |   |          |          |          |  |