

TOWNSHIP 7 NORTH, RANGE 6 EAST, W.R.M.

HOT SPRINGS COUNTY, WYOMING

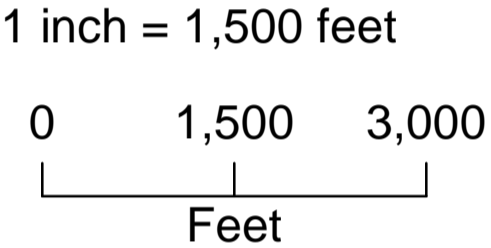
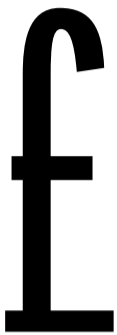
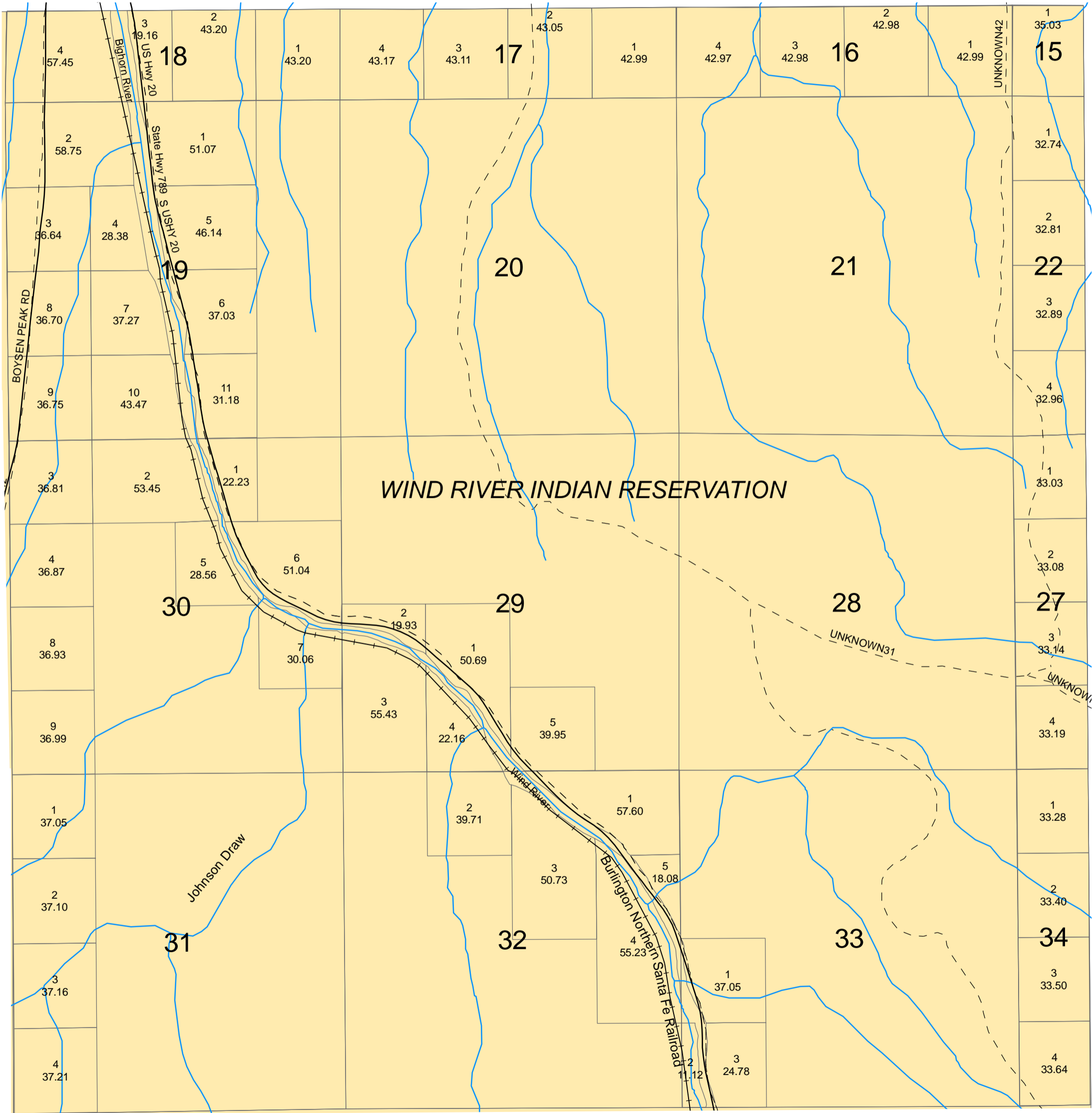

Legend

- USA_Lands
- County_Roads
- Private_Roads
- Hydrology
- Railroad

All or portion of the PLSS information on this document is subject to copyright by premier Data Services, they are not liable for any errors or inaccuracies.
 The Hot Springs County Assessor's office intends this map to be an aid in graphic representation of the displayed subject matter only.

