

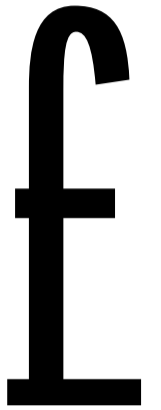

# TOWNSHIP 6 NORTH, RANGE 6 EAST, W.R.M. Enlargement 1

## HOT SPRINGS COUNTY, WYOMING

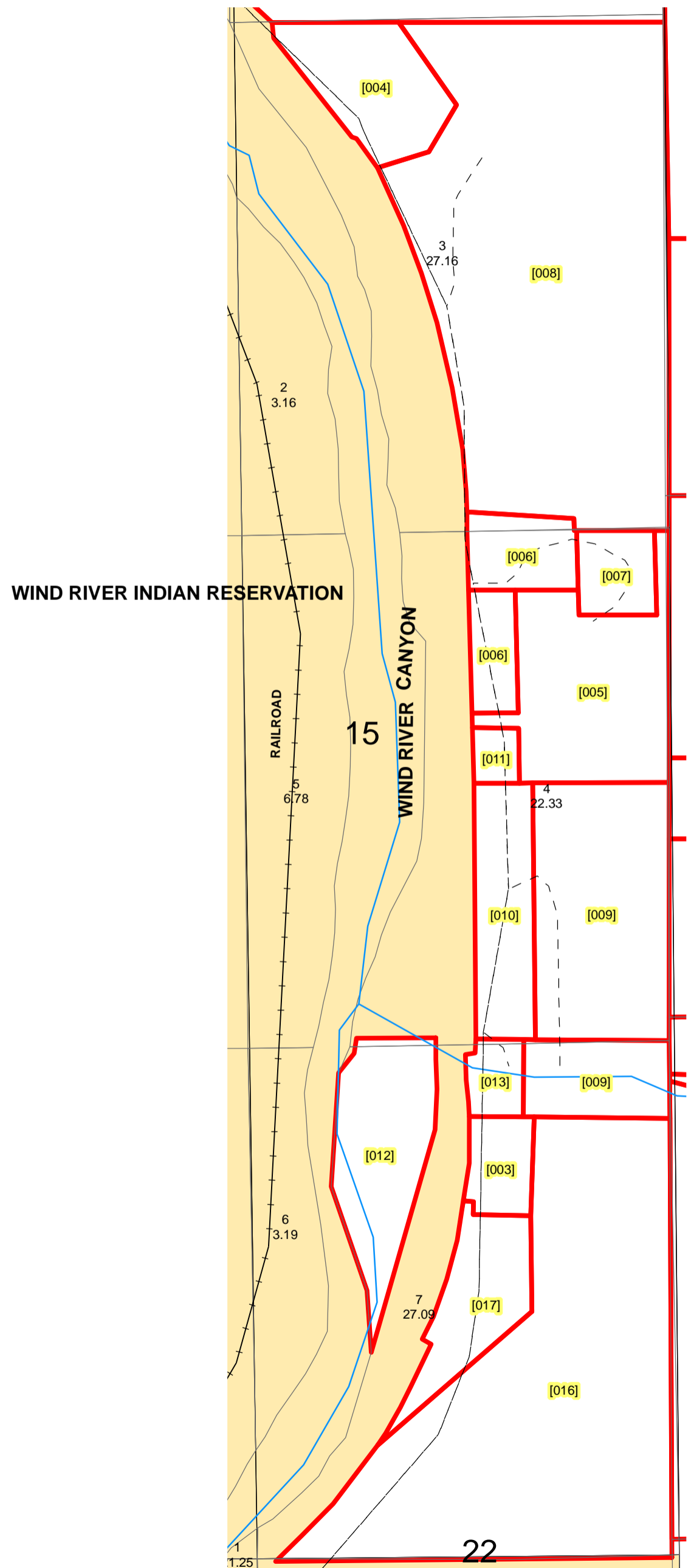

1 inch equals 300 feet

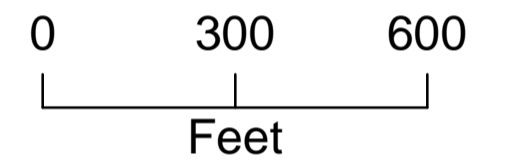

### Legend

- Private Roads
- +--- Railroad
- Hydrology
- ▭ Private\_Ownership
- ▭ USA Lands

All or portion of the PLSS information on this document is subject to copyright by premier Data Services, they are not liable for any errors or inaccuracies.

The Hot Springs County Assessors office intends this map to be an aid in graphic representation of the displayed subject matter only.

Hot Springs County Assessor's Office  
 Drawn by CGB 08/04/06  
 Revised 12/31/2008  
 Revised 7/15/2009

## Township 6 N Range 6 E Wind River Meridian

Plat #	Owner	Account	County #	Acres	Legal Description
001	WIDE OPEN INVESTMENTS LLC	R0003633	0587	128.92	6N-6E-9 LOTS 6,9,10, NESE (LESS 10.1 AC TO HWY) TOTAL ACRES 128.92
002	HURSH JOHN R & JUDY ANN LOPEZ	R0003649	0219	85.53	6N-6E-28 LOT 4 FR, LOT 13, 14 TOTAL ACRES 85.53
003	SHANOR ROGER E & MARCIA K	R0003638	0073	0.85	6N-6E-15 TRACT IN LOT 7 DESC BY METES & BOUNDS SURVEY ACRES-.954 EXCLUDING HWY R/W
004	PRICE RUTH A ETAL	R0003634	0869	36.62	6N-6E-15 LOT 1 (LESS .65 A H/W), LOT 3 FR DESC BY METES & BOUNDS TOTAL ACRES 36.62
005	WHITE TRUST	R0003639	0247	5.22	6N-6E-15 LOT 4 N/2 LESS FR SOLD TOTAL ACRES 5.22 THE HARRY R AND CHARLYNE M WHITE LIVING TRUST, DATED OCTOBER 16, 1998
006	JAMES ROBERT & SHARON	R0003635	0630	2.1	6N-6E-15 LOTS 3 & 4 FR
007	BARTHOLOMEW WILLIAM M & VALERIE A	R0003640	0209	1	6N-6E-15 LOT 4 FR TOTAL ACRES 1.0
008	PORATH DANIEL C S & LEILA H	R0003636	3772	22.32	6N-6E-15 LOT 3 FR LYING E OF HWY R/W TOTAL ACRES 22.32
009	RATELLE TRUST	R0003641	0890	7.05	6N-6E-15 LOT 4 FR LYING E OF U.S. H/W 20 & BEG AT SE COR OF LOT 4, THENCE W 350', THENCE N 660', THENCE E 350', THENCE S 660' TO PT OF BEGINNING 5.30 ACRES LOT 7 FR LYING EAST OF US H/W 20. BEG AT NE COR LOT 7, TH -- See Acct #R0003641 for Full Legal
010	SHANOR ROGER E & MARCIA K	R0003642	0727	1.88	6N-6E-15 LOT 4 S/2 LESS 11.85 A H/W & LESS 350'X 660' IN SE CORNER SOLD TO WOLFE 5.3 A TOTAL ACRES 1.88
011	PLYMALE SARAH ANN	R0003643	0716	0.38	6N-6E-15 LOT 4 N/2 FR & TR IN WIND RIVER CANYON APPROX 120' X 140' TOTAL ACRES .38
012	LUEHNE ROLAND WOLFGANG	R0003644	0725	4	6N-6E-15 LOT 7 FR LYING WEST OF U.S. HWY 20 TOTAL ACRES 4.0
013	BALOG MICHAEL J & DEBRA A	R0003645	0033	0.65	6N-6E-15 LOT 7 FR TOTAL ACRES .652
014	CANYON LIMITED LIABILITY CO	R0003648	0648	6.7	6N-6E-28 LOT 4 FR LYING WEST OF R/W LINE UW HWY 20
016	SHANOR ROGER E & MARCIA K	R0003646	3233	16.57	6N-6E-15 LOT 7 TRACT DESC BY METES & BOUNDS TOTAL ACRES 16.57
017	DARLINGTON ALLEN D & TODEEN L	R0003647	3386	2.08	6N-6E-15 LOT 7 TRACT DESC BY METES & BOUNDS TOTAL ACRES 2.078
500	U.S A.	None		85.65	6 N 6 E Sections:
501	U.S. IN TRUST	None		597.66	6 N 6 E Sections:
501	WIND RIVER INDIAN RESERVATION	None		3466.69	6 N 6 E Sections: