

# TOWNSHIP 47 NORTH, RANGE 97 WEST, 6TH P.M.

## HOT SPRINGS COUNTY, WYOMING

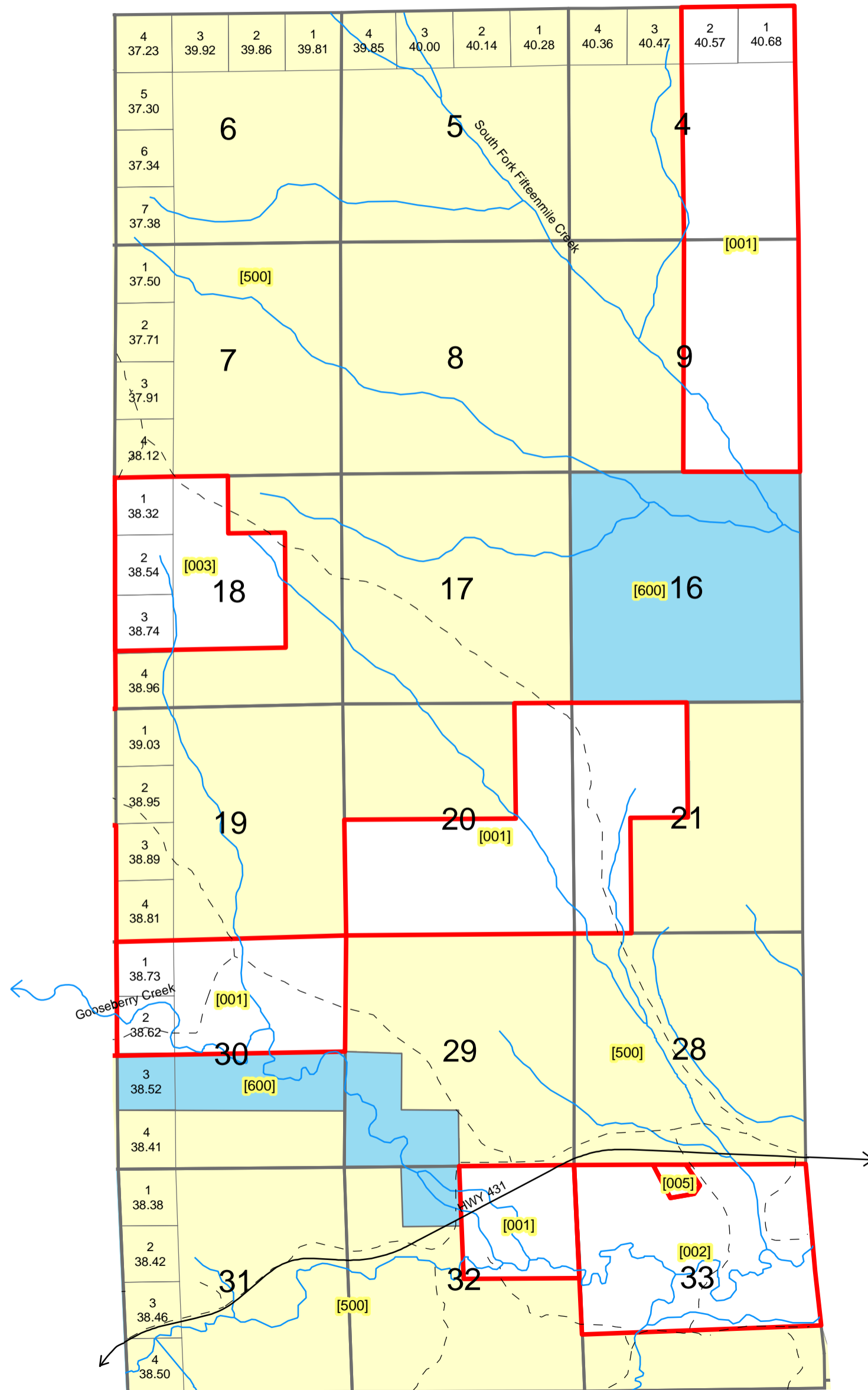

f

1 inch equals 2,640 feet

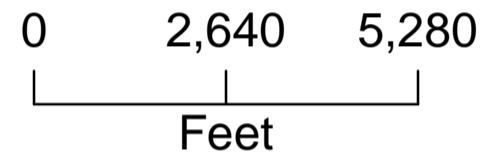

### Legend

- Private
- Statelands
- BLM
- Private\_Roads
- County\_Roads
- Hydrology

All or portion of the PLSS information on this document is subject to copyright by premier Data Services, they are not liable for any errors or inaccuracies.  
 The Hot Springs County Assessor's office intends this map to be an aid in graphic representation of the displayed subject matter only.

Hot Springs County Assessor's Office  
 Drawn by CGB 08/24/07  
 Revised 12/31/2008  
 Revised 7/15/2009

## Township 47 N Range 97 W Sixth Principal Meridian

Plat #	Owner	Account	County #	Acres	Legal Description
001	LU SHEEP CO	R0003163	3000	1758.6	47-97-04 LOTS 1,2,S/2NE, SE/4 47-97-09 E/2 47-97-20 S/2, E/2NE 47-97-21 NW/4, W/2SW 47-97-30 NWNE, NENE 47-97-32 NE/4 TOTAL ACRES 1758.60
002	PFISTER TRUST & LASHER TRUST	R0003165	3268	467.23	47-97-33 N/2, N/2S/2 LESS 12.77 A TO MILLER TOTAL ACRES - 467.23
003	HILLBERRY ENTERPRISES INC	R0003164	0654	315.6	47-97-18 LOTS 1,2,3, E/2NW, SWNE, NWSE, NESW TOTAL ACRES 315.60
005	MILLER MAHLON L &	R0003166	0089	12.77	47-97-33 TR IN NWNE & NENW TOTAL ACRES - 12.77
500	BLM	None		7968.59	47 N 97 W Sections:
600	STATE OF WYOMING	None		958.52	47 N 97 W Sections: