

# TOWNSHIP 45 NORTH, RANGE 100 WEST, 6TH P.M.

## HOT SPRINGS COUNTY, WYOMING

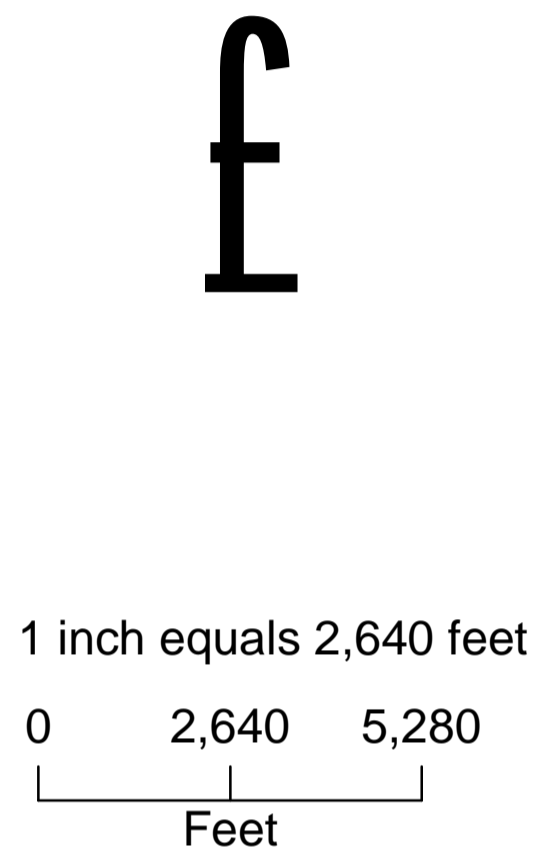
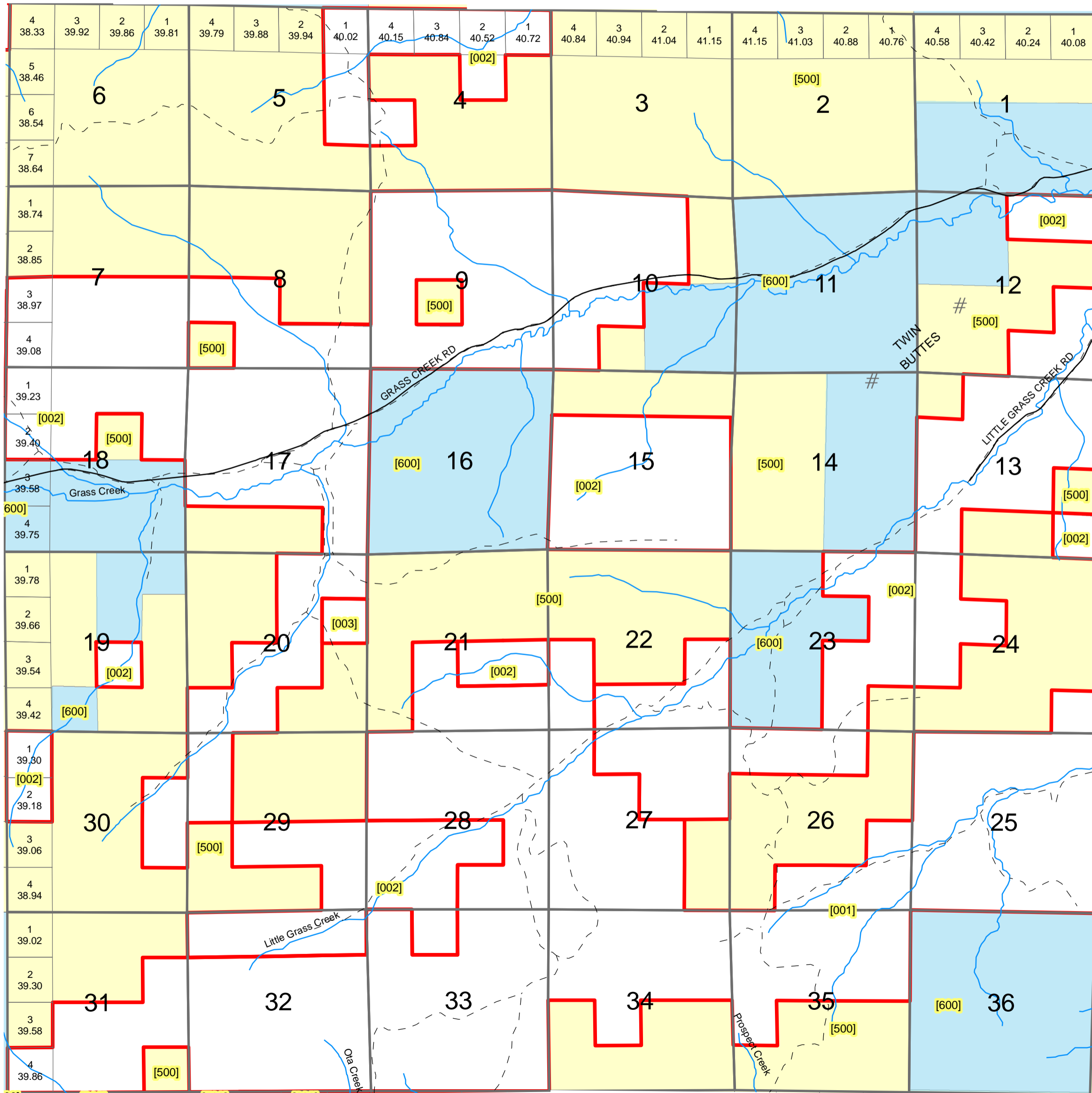

### Legend

- Private
- Statelands
- BLM
- County Roads
- Private Roads
- Hydrology

All or portion of the PLSS information on this document is subject to copyright by premier Data Services, they are not liable for any errors or inaccuracies.

The Hot Springs County Assessor's office intends this map to be an aid in graphic representation of the displayed subject matter only.

Hot Springs County Assessor's Office  
 Drawn by CGB 08/22/07  
 Revised 12/31/2008  
 Revised 7/15/2009

## Township 45 N Range 100 W Sixth Principal Meridian

Plat #	Owner	Account	County #	Acres	Legal Description
001	PROSPECT LAND & CATTLE LLC	R0003074	3061	3959.86	45-100-21 E/2SW, S/2SE 45-100-22 W/2SW 45-100-24 SESE 45-100-25 ALL 45-100-26 S/2SE, NESE, SESW 45-100-27 W/2NW, SENW, SW/4, W/2SE 45-100-28 N/2, SWSE, E/2SE 45-100-31 SENE, N/2SE, E/2SW SWSE, LOT 4 45-100-32 -- See Acct #R0003074 for Full Legal
002	L U SHEEP CO	R0003072	0937	5857.91	45-100-4 LOTS 1,2,3,4, SWNE, NWSW 45-100-5 LOT 1, SENE, NESE 45-100-7 LOT 3,4, E/2SW, SE/4 45-100-8 N/2SW, SESW, S/2SE 45-100-9 SESW, E/2NW, E/2, W/2W/2 45-100-10 NW/4, N/2SW, SWSW, W/2NE 45-100-12 N/2NE -- See Acct #R0003072 for Full Legal
003	L U SHEEP CO	R0003073	0215	40	45-100-20 SENE TOTAL ACRES 40.0 CORRESPONDS WITH PARCEL #8009
500	BLM	None		9453.11	45 N 100 W Sections:
600	STATE OF WYOMING	None		3719.33	45 N 100 W Sections: