

TOWNSHIP 44 NORTH, RANGE 96 WEST, 6TH P.M.

HOT SPRINGS COUNTY, WYOMING

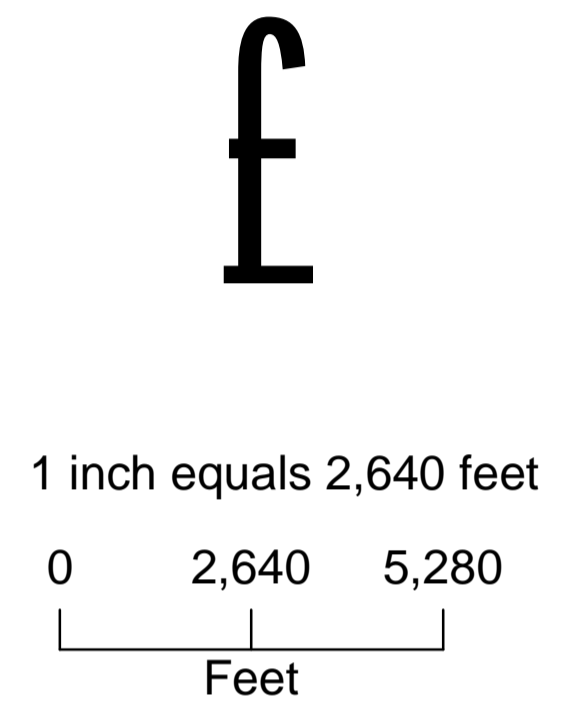
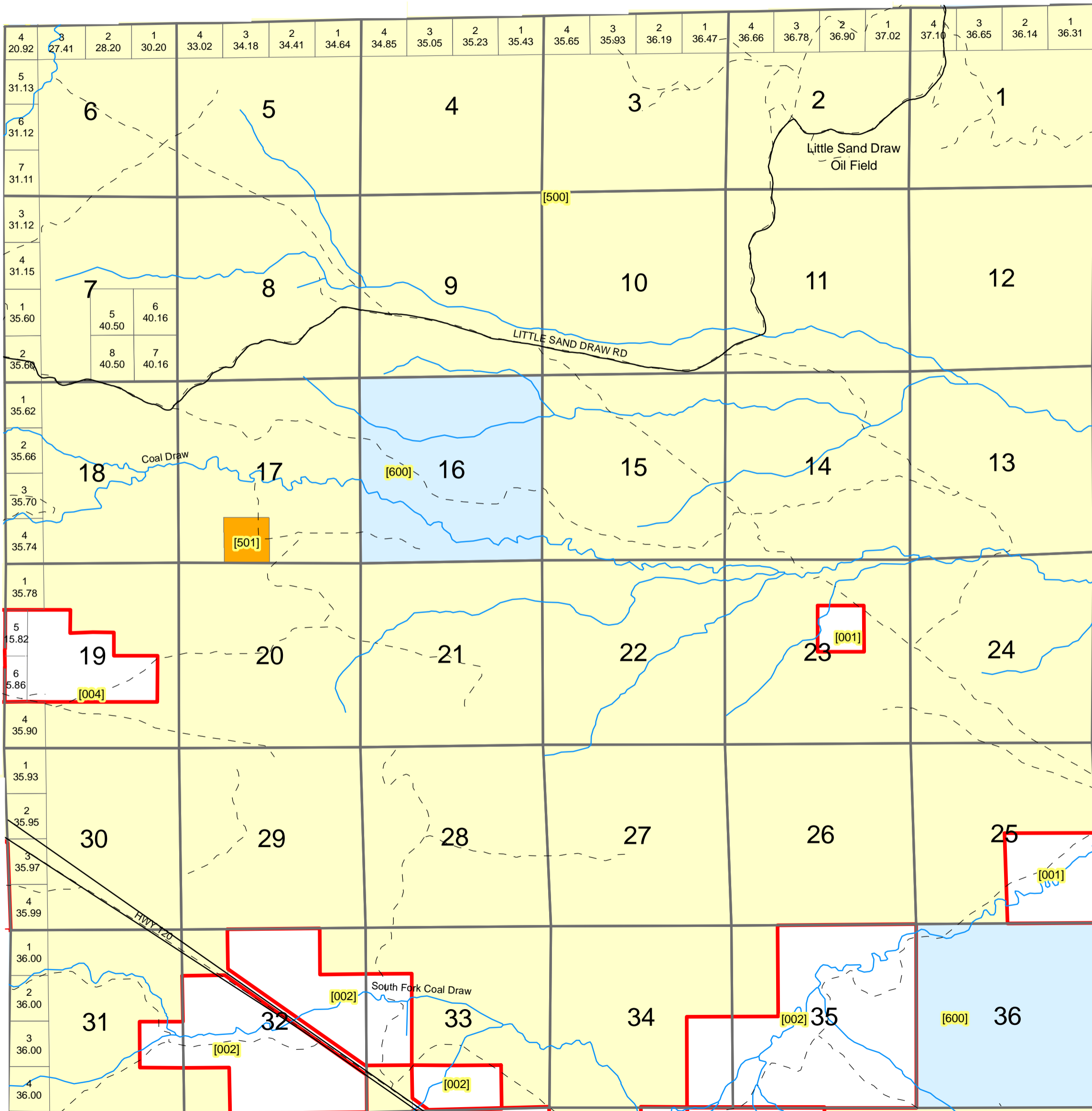

- Legend**
- Private
 - Statelands
 - BLM
 - USA_Land
 - County_Roads
 - Private_Roads
 - Hydrology

All or portion of the PLSS information on this document is subject to copyright by Premier Data Services, they are not liable for any errors or inaccuracies.

The Hot Springs County Assessor's office intends this map to be an aid in graphic representation of the displayed subject matter only.

Hot Springs County Assessor's Office
 Drawn by CGB 08/09/07
 Revised 12/31/2008
 Revised 7/15/2009

Township 44 N Range 96 W Sixth Principal Meridian

Plat #	Owner	Account	County #	Acres	Legal Description
001	HAY CREEK LAND & CATTLE CO LLC	R0003051	3142	200	44-96-23 SWNE 44-96-25 S2SE, N2SE TOTAL ACRES 200.0 MCNEIL PLACE
002	HOLDEN LAND COMPANY LLC	R0003052	3073	1334.49	44 96 31 NESE 44 96 32 S2N2,NENW,NWNE,N2S2,S2SE,SESW 44 96 33 SESW,SWSE,SWNW,NWSW,(LESS 25.51 AC. HW) 44 96 34 E2SE 44 96 35 S2,NE4,E2NW TOTAL ACRES 1334.49 TOM SANFORD UNIT CORRESPONDS W/ PARCEL #5940
004	SYRACUSE MINING CO	R0003050	0798	211.68	44-96-19 SWSWNE, E/2SWNW, W/2SENW, SESENW, NESW, E/2NWSW, , W/2NESE, NWSE, LOT 5, LOT 6 TOTAL ACRES 211.68
500	BLM	None		19691.76	44 N 96 W Sections:
600	STATE OF WYOMING	None		1280	44 N 96 W Sections: