

# TOWNSHIP 43 NORTH, RANGE 99 WEST, 6TH P.M. HOT SPRINGS COUNTY, WYOMING

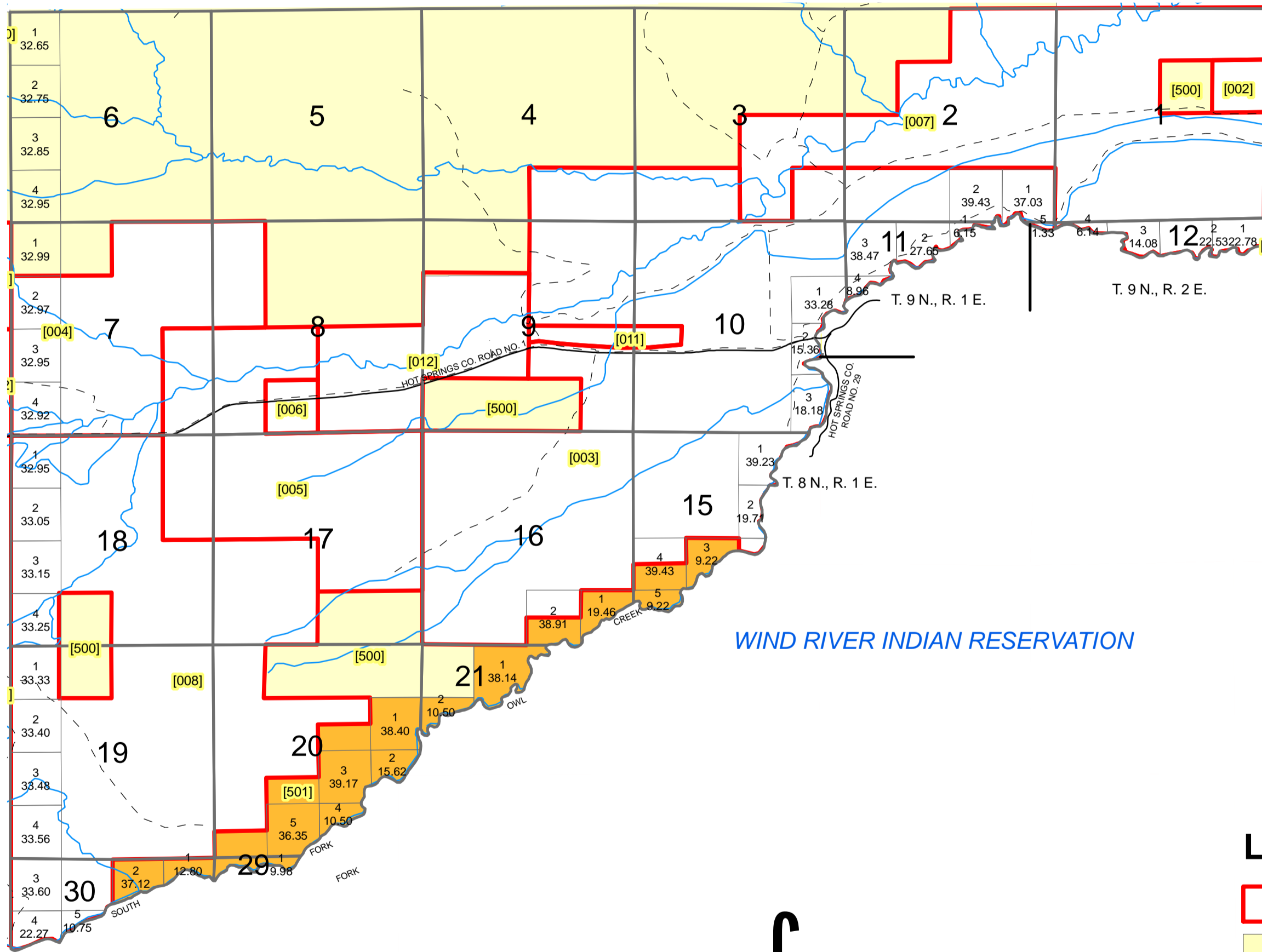

### Legend

- Private
- BLM
- USA\_Land
- County\_Roads
- Private\_Roads
- hydrology

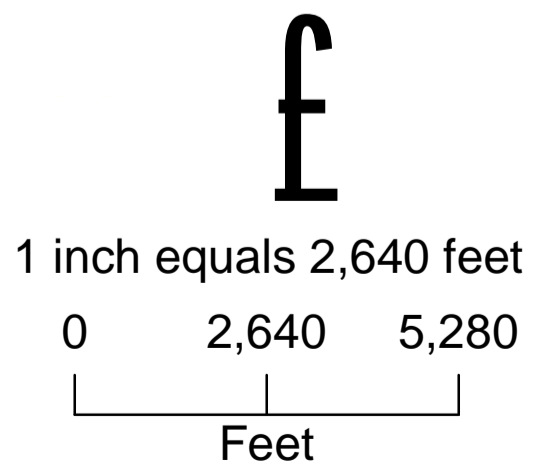

All or portion of the PLSS information on this document is subject to copyright by premier Data Services, they are not liable for any errors or inaccuracies.

The Hot Springs County Assessor's office intends this map to be an aid in graphic representation of the displayed subject matter only.

Hot Springs County Assessor's Office  
 Drawn by CGB 0720/07  
 Revised 12/31/2008  
 Revised 7/15/2009

## Township 43 N Range 99 W Sixth Principal Meridian

Plat #	Owner	Account	County #	Acres	Legal Description
002	H-TRIANGLE LIVESTOCK CO INC	R0002754	0664	40	43-99-01 SENE TOTAL ACRES 40.0 CORRESPONDS W/ PARCEL #5922
003	HAY CREEK LAND & CATTLE CO LLC	R0002756	0366	2062.15	43-99-02 LOTS 1,2, S/2SW 43-99-03 SESE, S2SW 43-99-04 S2SE 43-99-09 NE, SESE, N2SE FR 43-99-10 LOTS 1,2,3, NW, N2NE, SWNE, NWSE, NESW, S2SW, SWSE, NWSW S OF RD 43-99-11 LOTS 1,2,3,4 43-99-15 LOTS 1,2, N/2 LOT -- See Acct #R0002756 for Full Legal
004	VASS TRUST	R0002757	0840	538.84	43-99-07 LOT 2,3,4,SESW,SWSE,NESW,NWSE,NE/4,SENW 43-99-08 W/2NW TOTAL ACRES 538.84 HUGH G VASS REVOCABLE TRUST DATED THE 28TH DAY OF OCTOBER, 2008
005	PENNOYER & SON INC	R0002758	0377	676	43 99 07 E2SE 43 99 08 W2SW,NESW 43 99 17 N2,N2SE 43 99 18 E2NE TOTAL ACRES 676.0
006	OWL CREEK ASSOCIATES	R0002761	0579	38	43 99 08 SESW
007	HAY CREEK LAND & CATTLE CO LLC	R0002755	3178	1105.53	43-99-01 S2, NW, N2NE 43-99-02 N2S2, NE, SENW 43-99-03 W2SE, NESE 43-99-12 LOTS 1,2,3,4 TOTAL ACRES 1105.53
008	HAY CREEK LAND & CATTLE CO LLC	R0002764	3190	1552.79	43 99 17 SW 43 99 18 LOTS 1,2,3,4,E2NW, W2NE,NESW,SE 43 99 19 LOTS 1,2,3,4,E2SW, SE,SENW,NE 43 99 20 S2NW,NWSW,N2SWSW, NWNW,N2NESW,N2SWNE 43 99 30 LOTS 3,4,5,NENW TOTAL ACRES 1552.79
011	MILLER WILLIAM SCOTT & KRISTEN	R0002763	0528	58	43 99 09 N/2SE FR NORTH OF OWL CREEK RD 43 99 10 NWSW FR NORTH OF OWLCREEK RD TOTAL ACRES - 58
012	HART RODNEY IVAN & MARY LYNN	R0002762	0088	312	43 99 08 SE (LESS 4A RD) 43 99 09 S2NW,N2SW (LESS 4A RD),N2SE FR 43 99 10 NWSW FR TOTAL ACRES - 312.0
500	BLM	None		3204.19	43 N 99 W Sections:
501	INDIAN DEPT.	None		396.4	43 N 99 W Sections: