

TOWNSHIP 43 NORTH, RANGE 98 WEST 6TH P.M.

HOT SPRINGS COUNTY, WYOMING

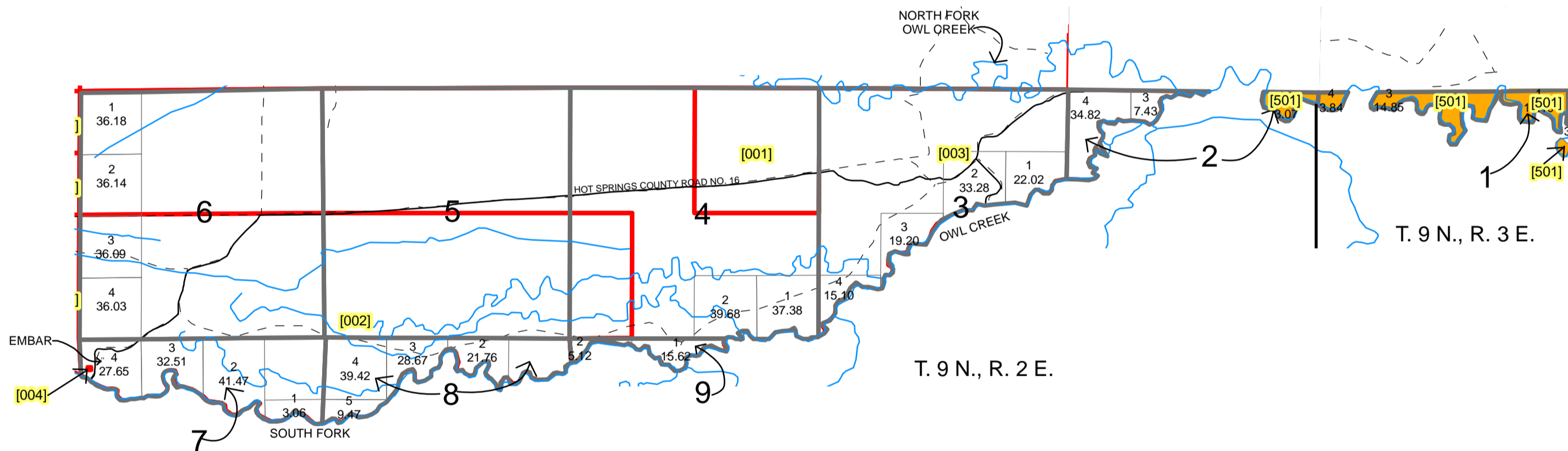

Legend

- Private
- USA_Land
- County_Roads
- Private_Roads
- Hydrology

1 inch equals 2,350 feet

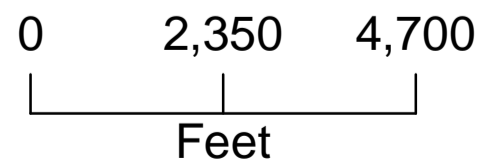

All or portion of the PLSS information on this document is subject to copyright by premier Data Services, they are not liable for any errors or inaccuracies.

The Hot Springs County Assessors office intends this map to be an aid in graphic representation of the displayed subject matter only.

Hot Springs County Assessor's Office
 Drawn by CGB 07/20/07
 Revised 12/31/2008
 Revised 7/15/2009

Township 43 N Range 98 W Sixth Principal Meridian

Plat #	Owner	Account	County #	Acres	Legal Description
001	MEYER TRUST	R0002752	0499	160	43 98 04 NE TOTAL ACRES 160.0 CORRESPONDS W/ PARCEL #5930
002	HAY CREEK LAND & CATTLE CO LLC	R0002753	0858	995.21	43-98-04 W2SW 43-98-05 S2 43-98-06 LOTS 3,4,E2SW,SE 43-98-07 LOTS 1,2,3,4,NENE, EXCEPT THAT PORTION CONVEYED TO THE HISTORICAL LANDMARK COMMISSION OF THE STATE OF WYOMING IN LOT 4 43-98-08 LOTS 1,2,3,4,5 TOTAL ACRES 995.21
003	H-TRIANGLE LIVESTOCK CO INC	R0002751	0342	1459.97	43-98-02 LOTS 3,4 43-98-03 LOTS 1,2,3,4,N/2N/2,NWSW,S/2NW 43-98-04 LOTS 1,2,NW/4,E/2SW,N/2SE 43-98-05 N/2 43-98-06 LOTS 1,2,E/2NW, NE/4 43-98-09 LOTS 1,2 (LESS 2 A RD) TOTAL ACRES 1459.97 CORRESPONDS W/ PARCEL #5922
501	U.S. IN TRUST	None		55.03	43 N 98 W Sections: 1,2