

TOWNSHIP 43 NORTH, RANGE 101 WEST, 6TH P.M.

HOT SPRINGS COUNTY, WYOMING

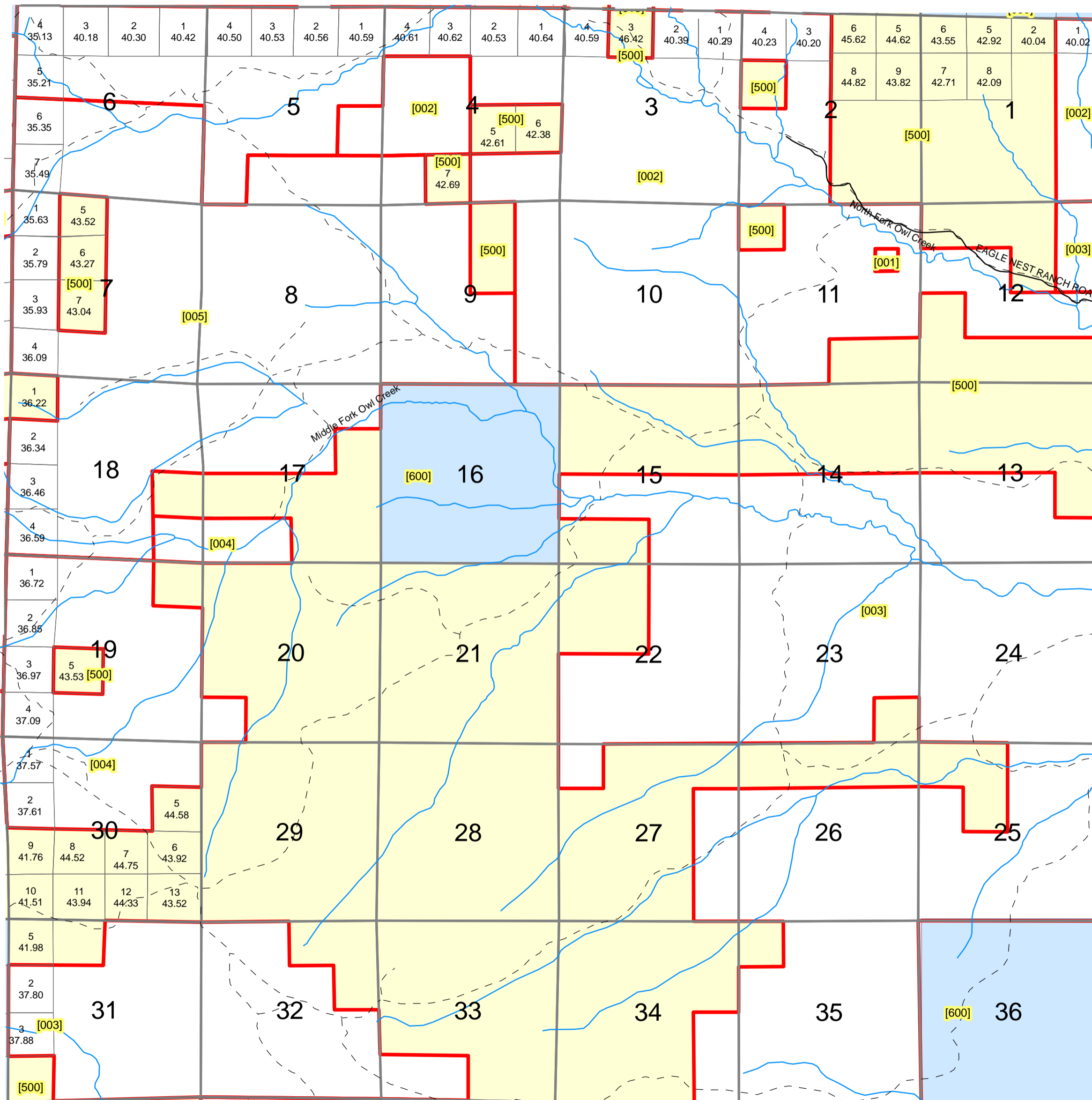

f

1 inch equals 2,640 feet
 0 2,640 5,280
 Feet

Legend

- Private
- Statelands
- BLM
- County_Roads
- Private Roads
- Hydrology

All or portion of the PLSS information on this document is subject to copyright by premier Data Services, they are not liable for any errors or inaccuracies.

The Hot Springs County Assessor's office intends this map to be an aid in graphic representation of the displayed subject matter only.

Hot Springs County Assessor's Office
 Drawn by CGB 07/23/07
 Revised 12/31/2008
 Revised 7/15/2009

Township 43 N Range 101 W Sixth Principal Meridian

Plat #	Owner	Account	County #	Acres	Legal Description
001	TALBOOM NANCY LYNN	R0001313	0112	10	43 01 11 SENE NW TOTAL ACRES 10.0
002	HAY CREEK LAND & CATTLE CO LLC	R0001311	3147	3867.64	43-01-01 LOT 1, SENE, E2SE 43-01-02 LOTS 3,4, SENW, SW 43-01-03 LOTS 1,2,4,S2N2, S2 43-01-04 LOTS 1,2,3,4, S2NE, S2SE, S2NW, N2SW 43-01-05 LOTS 1,2,3,4, S2N2,NWSE,NESW,W2SW,NESE 43-01-06 LOTS 1,2,3,4,5, S2NE, -- See Acct #R0001311 for Full Legal
003	HAY CREEK LAND & CATTLE CO LLC	R0001315	3195	5515.68	43-01-13 SW/4,W/2SE,SESE 43-01-14 S/2 43-01-15 N/2S/2,S/2SE 43-01-22 NE/4,S/2 43-01-23 N/2,SW/4,N/2SE,SWSE 43-01-24 ALL 43-01-25 NE/4,SWNW,S/2 43-01-26 S/2N/2,S/2 43-01-27 SENE,E/2SE,NWNW 43-01-31 LOTS 2,3 -- See Acct #R0001315 for Full Legal
004	PENNOYER & SON INC	R0001314	3035	1062.81	43-101-12 E/2NE 43-101-17 S/2SW 43-101-18 SESE 43-101-19 LOTS 1,2,3,4, NENW,SENW, NWNE,SESW, SE/4,S/2NE 43-101-20 SWSW 43-101-30 LOTS 1,2, E/2NW, SWNE, N/2NE TOTAL ACRES 1062.81
005	HAY CREEK LAND & CATTLE CO LLC	R0001312	3135	2803.67	43-01-04 SWSW 43-01-05 SESW, S2SE 43-01-06 LOTS 6,7, E2SW, SE 43-01-07 LOTS 1,2,3,4, E2, SESW 43-01-08 W2, E2 43-01-09 W2, W2SE 43-01-17 N2N2, S2NW, SWNE 43-01-18 LOTS 2,3,4, N2NE, S2NE, SENW, E2SW, W2SE, NE -- See Acct #R0001312 for Full Legal