

TOWNSHIP 42 NORTH, RANGE 101 WEST, 6TH P.M.

HOT SPRINGS COUNTY, WYOMING

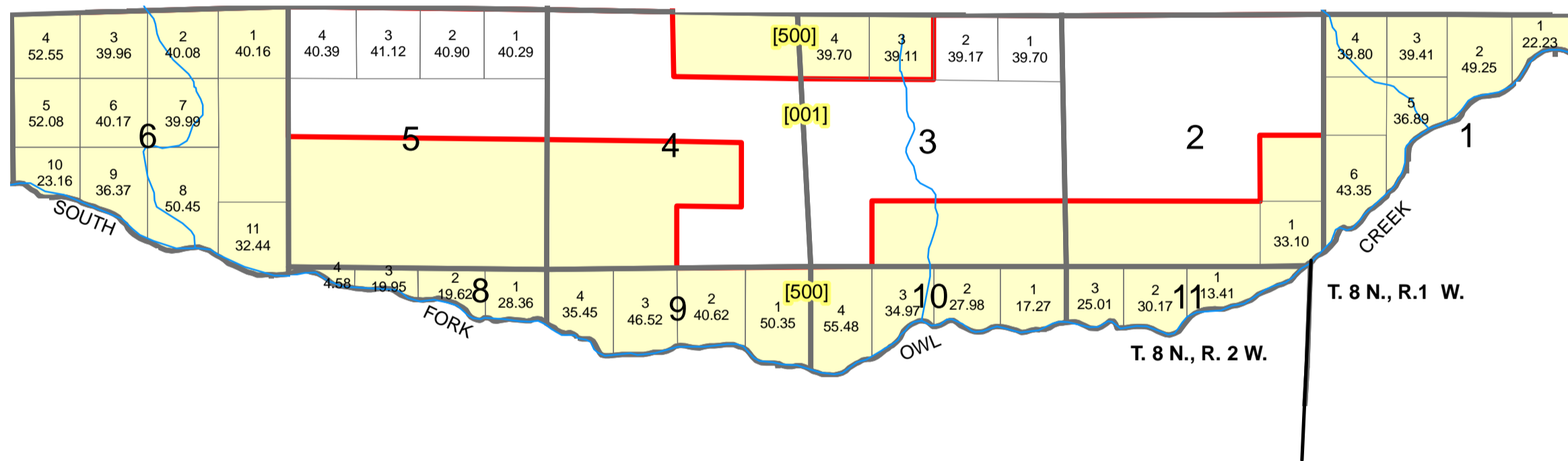

WIND RIVER INDIAN RESERVATION

Legend

- Private
- BLM
- Private Roads
- Hydrology

1 inch equals 2,640 feet

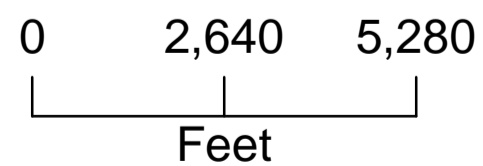

All or portion of the PLSS information on this document is subject to copyright by premier Data Services, they are not liable for any errors or inaccuracies.

The Hot Springs County Assessor's office intends this map to be an aid in graphic representation of the displayed subject matter only.

Hot Springs County Assessor's Office
 Drawn by CGB 07/05/07
 Revised 12/31/08
 Revised 7/15/2009

Township 42 N Range 101 W Sixth Principal Meridian

Plat #	Owner	Account	County #	Acres	Legal Description
001	HAY CREEK LAND & CATTLE CO LLC	R0000067	0404	1561.54	42-01-02 N2SW, NWSE, N2 42-01-03 LOTS 1,2, S2N2, N2S2, SWSW 42 01 04 NW, S2NE, E2SE, SWSE 42 01 05 LOTS 1,2,3,4, S2N2 TOTAL ACRES 1561.54 HYDES HOLE CABIN
500	BLM	None		2265.87	42 N 101 W Sections: