

TOWNSHIP 41 NORTH, RANGE 92 WEST, 6TH P.M.

HOT SPRINGS COUNTY, WYOMING

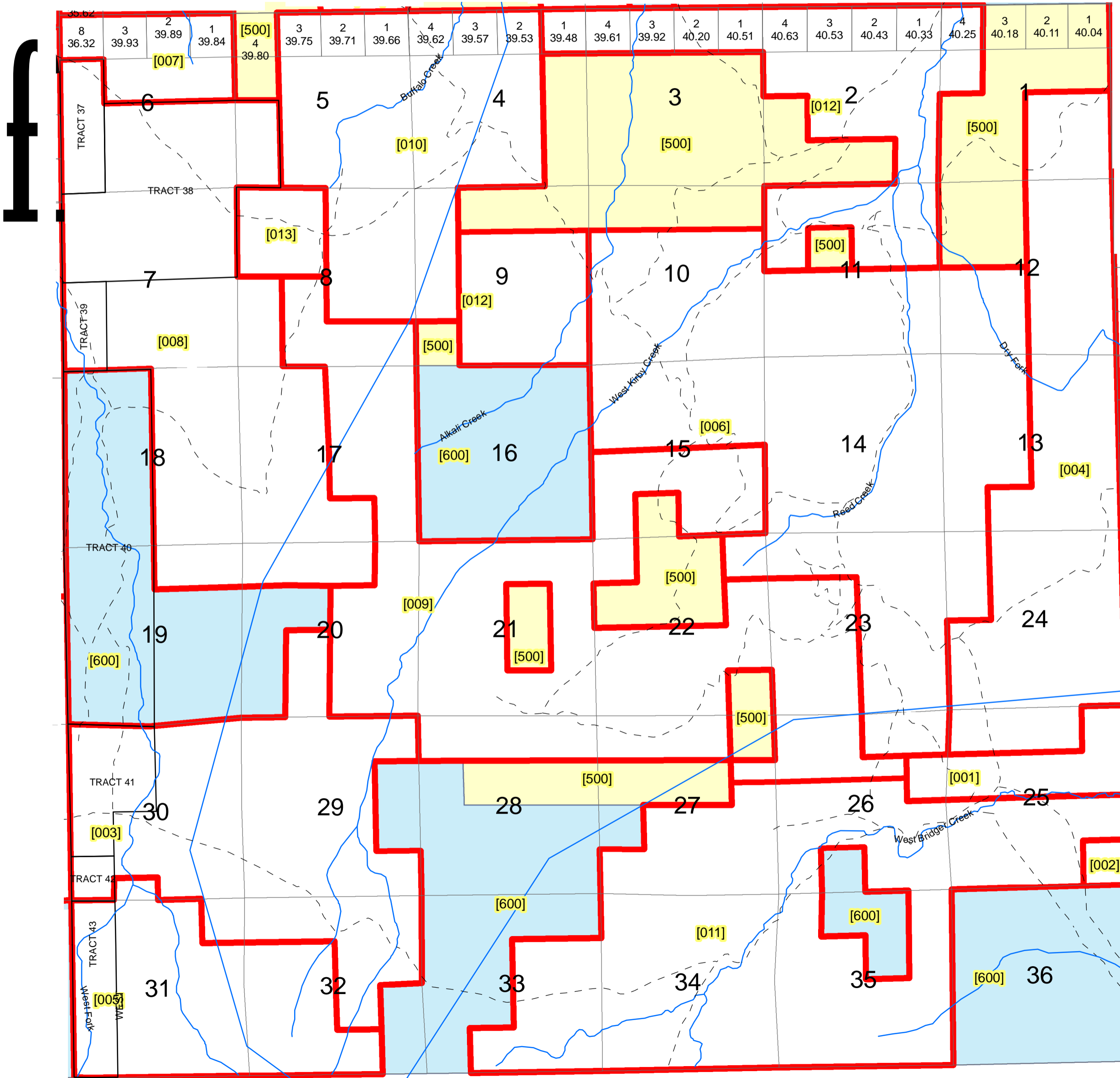

1 inch equals 2,640 feet

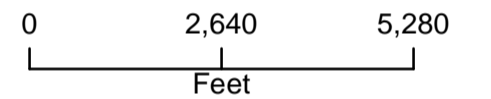

Legend

- Private
- Statelands
- BLM
- County Roads
- Private Roads
- Hydrology

All or portion of the PLSS information on this document is subject to copyright by premier Data Services, they are not liable for any errors or inaccuracies.
The Hot Springs County Assessor's office intends this map to be an aid in graphic representation of the displayed subject matter only.

Hot Springs County Assessor's Office
 Drawn by CGB 05/25/05
 Revised 7/15/2009

Township 41 N Range 92 W Sixth Principal Meridian

Plat #	Owner	Account	County #	Acres	Legal Description
001	PHILP SHEEP CO	R0000036	3045	240	41-92-25 S/2NE, NENE, S/2NW 41-92-26 SENE TOTAL ACRES 240.0
002	BATTLE AXE CATTLE CO INC	R0000038	0113	40	41 92 25 SESE ACRES 40.0
003	V VENTURES LLC	R0000035	0841	1580.06	41 92 20 E2SW 41 92 29 W2,W2E2,NENE,SESE 41 92 30 TR 41 (LOTS 1,2,3,W/2NW) 41 92 30 E2NW,TR42 (SWSW),E2, NESW,N2SESW 41 92 31 NENE 41 92 32 NWNW,E2NE,W2NE,NENW,NWSE TOTAL ACRES 1580.06 PERPETUAL EASEMENT TO VE -- See Acct #R0000035 for Full Legal
004	HALL BUTTE RANCH LLC	R0000028	0895	1520	41 92 01 SE 41 92 12 E2 41 92 13 E2,SESW 41 92 24 E2NW,NE,S2 41 92 25 N2NW,NWNE TOTAL ACRES - 1520.00
005	DIAMOND X RANCH LLC	R0000039	0017	900.38	41-92-30 S/2, SESW 41-92-31 SENE, W/2NE, E/2NW, E/2SW, SE/4, TR 43 A,D,E,F 41-92-32 S/2NW, SW/4, SWSE TOTAL ACRES 900.38
006	REED CREEK LIMITED PARTNERSHIP	R0000034	0634	2800	41-92-10 S/2N/2, SW/4, SE/4 41-92-11 S/2 41-92-12 SW/4 41-92-13 NW/4, N/2SW, SWSW 41-92-14 ALL 41-92-15 N/2 41-92-22 NENE 41-92-23 E/2, N/2NW 41-92-24 W/2NW 41-92-26 N/2NE TOTAL ACRES 2800.0
007	NICHOLS KENNETH G ET-AL	R0000031	3879	275.98	41-92-6 LOTS 1,2,3,8, S/2NE, SENW TOTAL ACRES 275.98
008	WALSH LAND & LIVESTOCK LLC	R0000030	0225	2061.91	41-92-5 W/2SW 41-92-6 LOTS 5,6,7, E/2SW, SE (EXCEPT 1.5A FR IN 5 & 6) 41-92-7 ALL 41-92-8 W/2SW 41-92-17 W/2, SWSE 41-92-18 E/2 41-92-19 N/2NE 41-92-20 N/2NW, NWNE TOTAL ACRES 2061.91
009	HENTHORNE LIMITED PARTNERSHIP	R0000033	0313	2600	41-92-8 E/2SW, S/2SE 41-92-15 N/2S/2, SWSW, S/2SE 41-92-17 NE/4, N/2SE, SESE 41-92-20 SE/4, S/2NE, NENE 41-92-21 ALL EXCEPT SWNE & NWSE 41-92-22 NWNW, SENE, N/2S/2, S/2SW, SWSE 41-92-23 S/2NW, SW/4 41-92-26 -- See Acct #R0000033 for Full Legal
010	HENTHORNE LIMITED PARTNERSHIP	R0000029	0183	1317.84	41-92-4 LOTS 2,3,4, S/2NW, SWNE, W/2SE, SW/4 41-92-5 LOTS 1,2,3, S/2NE, SE/4, E/2SW, SENW 41-92-8 NE/4, N/2SE 41-92-9 W/2NW/4, NWSW TOTAL ACRES 1317.84
011	V VENTURES LLC	R0000037	0119	2360	41 92 25 N2SE,SWSE,SW 41 92 26 S2S2NW,S2SWNE,N2S2, S2SE,SWSW 41 92 27 S2SENE,SE,E2SW,SWSW 41 92 33 S2NE,SE,SESW 41 92 34 ALL 41 92 35 E2NE,S2NW,NWNW,S2 TOTAL ACRES 2360.0 SCALE PENS-A FRAME-COW CAMP
012	REED CREEK LIMITED PARTNERSHIP	R0000027	3041	1401.89	41-92-01 W/2NW 41-92-02 N/2,NESW,N/2SE,SESE 41-92-03 N/2N/2 41-92-04 NENE 41-92-09 SENW, S/2NE, E/2SW, SE/4 41-92-11 N/2NW, SWNW, NE/4 TOTAL ACRES - 1401.89
013	AXTELL RANCHES LLC	R0000032	0061	160	41 92 08 NW TOTAL ACRES 160.0
500	BLM	None		2400.12	41 N 92 W Sections:
600	STATE OF WYOMING	None		3400	41 N 92 W Sections: