

MAP OF THE KINNEY SECOND ADDITION TO THE TOWN OF THERMOPOLIS Wyoming

Surveyed and plotted by E. J. H. D. Lopez

**D E B I Z I O N**  
 Commencing the center of the 1/4 section of Warren and Eleventh Streets on Corner No. 1. Thence west 1320 ft. to corner 2. Thence south 1/2 section line to center of Section 35 T. 43. N. R. 95. W. 404 ft. to 1/4 corner on south side of said section 35. Thence south 1/2 section line through Section 2, T. 42. N. R. 95. W. 986 ft. to north side of alley in block 21, on corner 3. Thence east 1320 ft. to center of 11th Street, on corner 4. Thence 720 ft. to corner No. 1, on place of beginning. A. D. Lopez surveyor

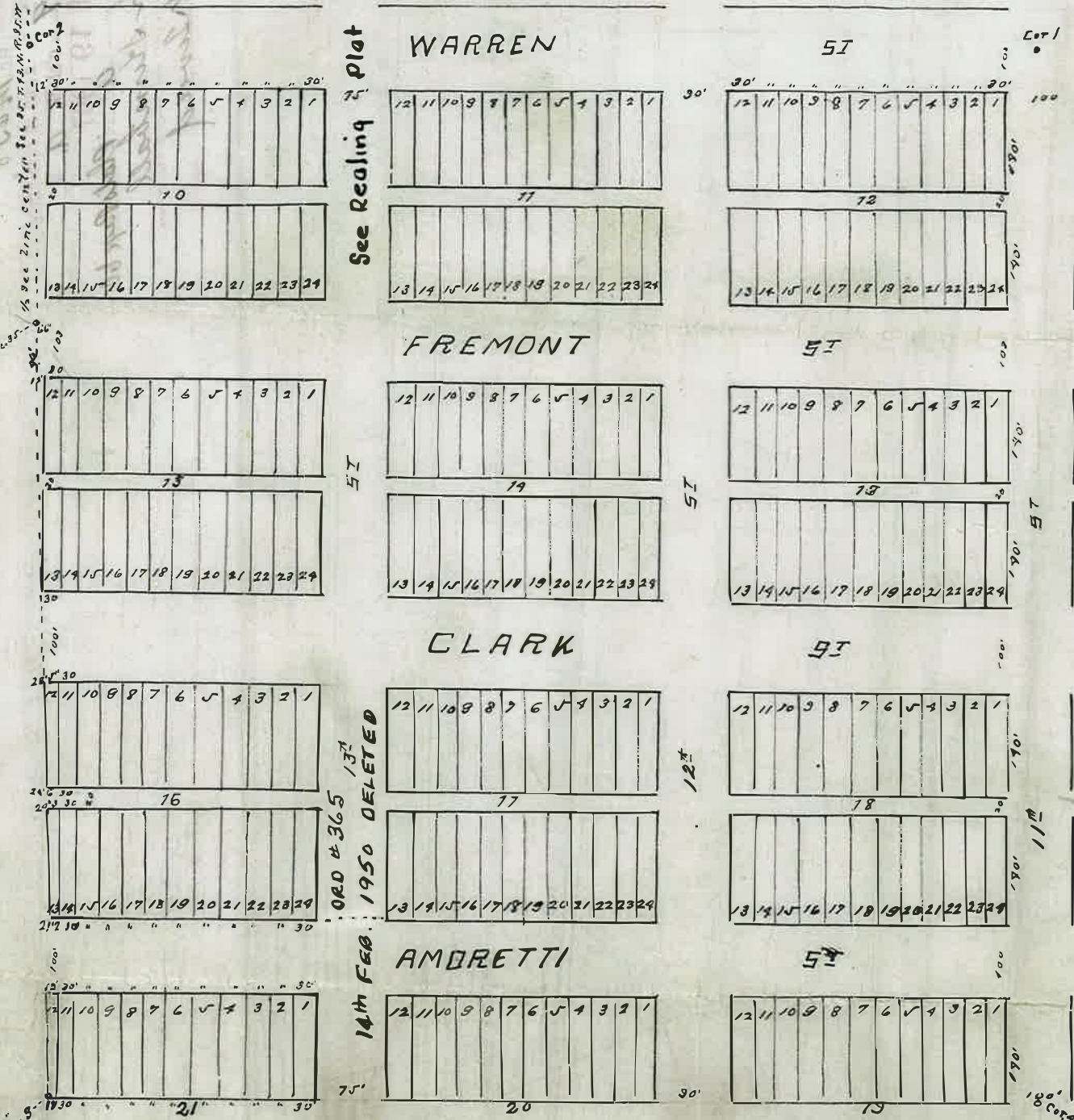

Know all men by these presents that we J.M. Beatty and Fred Wyckoff President & Secretary respectively of the Thermopolis Investment & Irrigation Co and proprietors, caused the land embraced in the above plat to be surveyed and plotted as the Kinney Second Addition to the Town of Thermopolis and that the streets and alleys shown on said plat are hereby dedicated to the use of the public Thermopolis Investment & Irrigation Co.

Signed and sealed in presence of  
 A. E. Carrier  
 J.M. Beatty Pres.  
 Fred Wyckoff Secy

State of Iowa  
 County of Benzon  
 I, J.M. Beatty & Fred Wyckoff  
 In this day of \_\_\_\_\_ 1907  
 known to be the persons who  
 executed the above dedication and acknowledged the same to their free will and deed  
 my Commission Expires July 4th 1907  
 E. Murphy  
 Notary Public



for record at 9 o'clock A.  
OCT 19 1907

Plats Page 60.  
Ralph Stimpall  
Albert Zavad

TO THE TOWN OF GREENWICH  
THE NIMBY SECOND ADDITION

W. DAVIS & CO

WARREN

See Record of Plat

1	2	3	4	5	6	7	8	9	10	11	12	13	14	15	16	17	18	19	20

21

1	2	3	4	5	6	7	8	9	10	11	12	13	14	15	16	17	18	19	20

22

FISEWOMY

1	2	3	4	5	6	7	8	9	10	11	12	13	14	15	16	17	18	19	20

23

1	2	3	4	5	6	7	8	9	10	11	12	13	14	15	16	17	18	19	20

24

25

CLARK

1	2	3	4	5	6	7	8	9	10	11	12	13	14	15	16	17	18	19	20

26

1	2	3	4	5	6	7	8	9	10	11	12	13	14	15	16	17	18	19	20

1492 DEFERED  
1493  
1494  
1495  
1496  
1497  
1498  
1499  
1500  
1501  
1502  
1503  
1504  
1505  
1506  
1507  
1508  
1509  
1510  
1511  
1512  
1513  
1514  
1515  
1516  
1517  
1518  
1519  
1520  
1521  
1522  
1523  
1524  
1525  
1526  
1527  
1528  
1529  
1530  
1531  
1532  
1533  
1534  
1535  
1536  
1537  
1538  
1539  
1540  
1541  
1542  
1543  
1544  
1545  
1546  
1547  
1548  
1549  
1550  
1551  
1552  
1553  
1554  
1555  
1556  
1557  
1558  
1559  
1560  
1561  
1562  
1563  
1564  
1565  
1566  
1567  
1568  
1569  
1570  
1571  
1572  
1573  
1574  
1575  
1576  
1577  
1578  
1579  
1580  
1581  
1582  
1583  
1584  
1585  
1586  
1587  
1588  
1589  
1590  
1591  
1592  
1593  
1594  
1595  
1596  
1597  
1598  
1599  
1600

27

ANDRETTI

1	2	3	4	5	6	7	8	9	10	11	12	13	14	15	16	17	18	19	20

28

1	2	3	4	5	6	7	8	9	10	11	12	13	14	15	16	17	18	19	20

Having examined the plat of the second addition of the town of Greenwich, in the County of Kent, State of New York, and the same being correct, I hereby certify that the same is in conformity with the provisions of the laws of this State in that behalf made.

John D. ...

John D. ...

John D. ...

Building Township of Greenwich